

Inline machine installation precautions

- There are two types of T-type connectors, one with a large aperture and one with a small aperture.

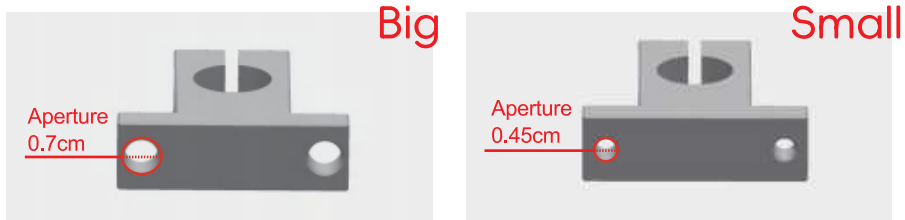

- Please use the screws in the accessory bag. Do not use too long screws without permission. Too long screws may cause damage to the circuit board hardware.

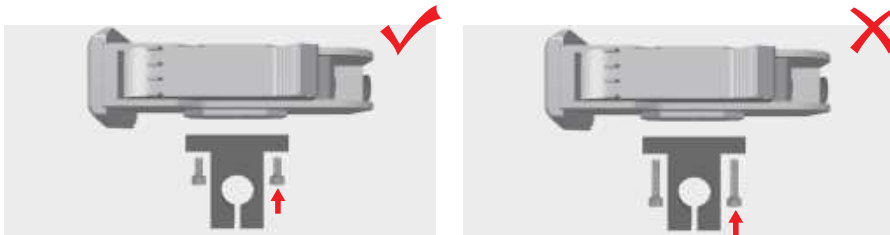

- The best printing distance is 3-5mm.

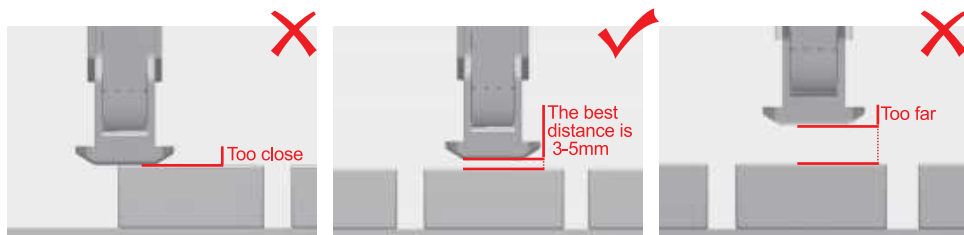

- The nozzle should be perpendicular to the direction of product movement, if parallel, the printing effect is a black line.

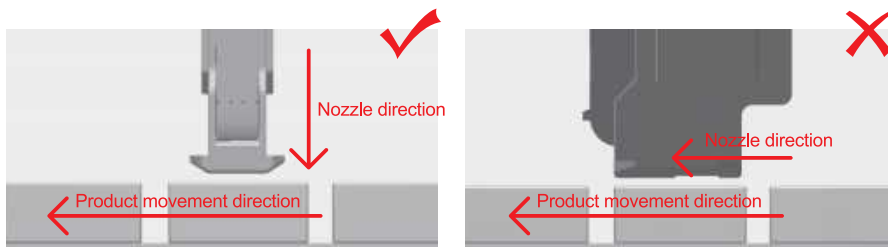

- Do not share the electrical socket with other electrical equipment. In principle, it is recommended to use a separate electrical socket to power the printer.

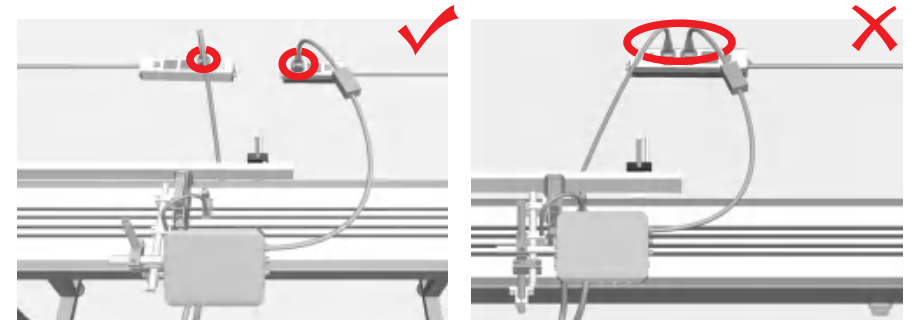

- In principle, before turning on the machine, install the ink cartridge on the print head. After turning off the machine, wait 30 seconds before replacing or removing the ink cartridge. Do not install the ink cartridge during the power-on and power-off process. It is forbidden to directly unplug and plug the print head connection line when the machine is powered on.

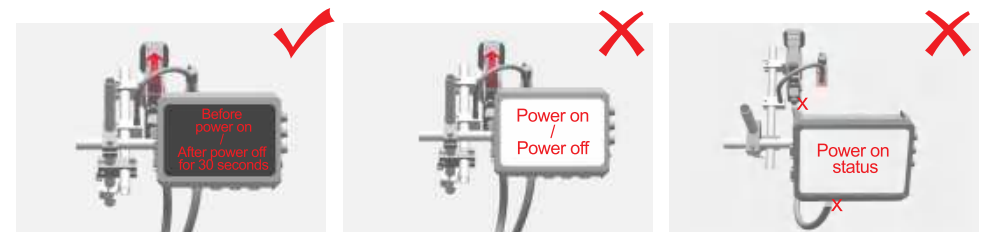

Other precautions:

- In principle, the controller should not be installed near strong interference sources such as motors and electric pumps;
- If the cutter signal or PLC signal is used, do not connect the power cord (pin 1 of the host photoelectric interface is left unconnected);
- Do not use a power adapter that is not standard equipped by our company.
- In the printing state, do not remove the ink cartridge. You must stop the printing state before performing operations.
- When the machine is not in use, remove the ink cartridge from the print head and cover it with the ink cartridge protective cover and store it in a cool place. Do not place it in direct sunlight or high temperature environment.

1. Install the bracket

- There are two types of T-type connectors, one large aperture and one small; the large aperture connector is used to fix the encoder bracket and connect the aluminum conveyor. Mixing use will cause loose fixation or damage to the circuit board.

2. Install the print head

- Lock the T-type connector on the print head. Please use the screws in the accessory package. Do not use too long screws. Too long screws can easily cause damage to the circuit board;
- When choosing vertical spraying (nozzle facing down) application, the nozzle should be installed as horizontally as possible. The best printing distance between the nozzle and the surface of the product is 3-5mm. The closer the nozzle is to the surface of the substrate, the better the printing effect;
- The nozzle should be perpendicular to the direction of product movement. If it is parallel, the printing effect is a black line.

3. Install the controller

- After the controller is fixed to the bracket, tighten the fixing screws;
- The controller should not be installed near strong interference sources such as motors and electric pumps;
- Take out the connecting cable, insert one end into the controller interface and tighten the ring lock, insert the other end into the print head interface and tighten the ring lock, and make sure that the ring lock is completely locked and screwed to the limit position. For multi-head machines, make sure that the host and nozzle interfaces correspond to each other, for example, interface 1 connects to print head 1, and interface 2 connects to print head 2.

4. Install the photocell sensor

- Take out the screws and L-shaped bracket in the photocell sensor package, fix the L-shaped bracket to the corresponding screw hole of the print head, and then install the photocell sensor on the L-shaped bracket, insert the photocell sensor plug into the controller interface and tighten the ring lock;
- If other types of photocell sensors are used, should select NPN NO type and PNP NC type with a rated voltage of 12V; when wiring, must follow the photocell sensor wire sequence and the controller photocell sensor interface pin wire sequence-corresponding connection (photocell sensor brown line corresponds to pin 1 of the controller interface, blue line corresponds to pin 2 of the controller interface, and black line corresponds to pin 3 of the controller interface);
- If using the cutter signal or PLC signal, do not connect the power line (pin 1 of the host photoelectric interface is left hanging).

5. Install the encoder (optional)

- During installation, be sure to tighten the bracket screws, insert the encoder plug into the controller encoder interface and tighten the ring lock;
- Adjust the spring pressure of the synchronous wheel to the appropriate strength to ensure smooth rolling without slipping;
- The rolling direction of the synchronous wheel must be parallel to the movement direction of the product. If it is tilted or twisted, it will cause uneven printing fonts and poor splicing effects;
- The encoder should be installed in the same movement range as the nozzle (the closer to the nozzle, the better the installation performance);
- If the synchronous wheel is pressed on the transmission wheel, the active wheel should be selected to avoid stretching or compression of the printed content caused by speed difference, and poor splicing effects;
- Our products use 4-thread encoders. If use other types of encoders, should select an NPN encoder with a rated voltage of 5V; when wiring, the encoder line sequence and the controller encoder interface pin line sequence must be followed-corresponding connection (controller interface pin 1 is VCC, pin 2 is GND, pin 3 is A phase signal, and pin 4 is B phase signal).

6. Power adapter installation

- First, insert the power adapter plug into the controller power interface, and then insert the three-core AC plug into the electrical socket; do not share the electrical socket with other electrical equipment. It is recommended to use a separate electrical socket to power the printer;
- Do not use a power adapter other than the company's standard power adapter.

7. Precautions for powering on the machine

- Make sure that the power plug, print head connection cable plug, photocell sensor plug, and encoder plug are firmly installed;
- Install the ink cartridge before turning on the machine. After turning off the machine, wait for 30 seconds before replacing or removing the ink cartridge. Do not install the ink cartridge during the power on and off process;
- Do not turn the machine on and off frequently. After pressing the power button, please wait patiently for the screen to light up; This device is designed with a power-off protection function. Frequent pressing of the power button will cause power-on failure or a white screen or freeze;
- Do not remove the ink cartridge when printing. Must stop printing before operating;
- When the machine is not in use, please remove the ink cartridge from the nozzle, cover it with the ink cartridge protective cover, and store it in a cool place. Do not place it in an exposed or high temperature environment;
- Do not directly unplug and plug the print head connection cable when powered on.